



# **iJRASET**

International Journal For Research in  
Applied Science and Engineering Technology



---

# **INTERNATIONAL JOURNAL FOR RESEARCH**

IN APPLIED SCIENCE & ENGINEERING TECHNOLOGY

---

**Volume: 5**

**Issue: I**

**Month of publication: January 2017**

**DOI:**

**[www.ijraset.com](http://www.ijraset.com)**

**Call: ☎ 08813907089**

**E-mail ID: [ijraset@gmail.com](mailto:ijraset@gmail.com)**

# Steering System of Electric Go-Kart

Mohd Yousuf Ahmed<sup>1</sup>, Asfan Mohiuddin<sup>2</sup>, Mohd Sayeed<sup>3</sup>, Kalamullah Akhtar<sup>4</sup>, Md Nawaz<sup>5</sup>, Mohammad Abrar Mohiuddin<sup>6</sup>

<sup>1,2</sup>Assistant Professor of Mechanical Department, Lords Institute of Engineering and Technology, Hyderabad

<sup>3,4,5,6</sup>Students of Mechanical Department, Lords Institute of Engineering and Technology, Hyderabad

**Abstract:-** Manual rack and pinion steering systems are commonly used due to their simplicity in construction and compactness. The main purpose of this paper is to design and Manufacture manual rack and pinion steering system according to the requirement of the vehicle for better Manoeuvrability. Quantities like turning circle radius, steering ratio, steering effort, etc. Are inter-dependent on each other and therefore there are different design consideration according to the type of vehicle. A virtual rack and pinion assembly can be created using software like Solid works and Ansys.

**Keywords:** Go-kart, Rack and pinion, Ansys, Ackerman, camber, caster.

## I. INTRODUCTION

The steering system is of important part of the dynamic design of any automobile to facilitate a smooth change of directions and make use of the tires ability to generate lateral forces to the highest extent. A racing driver's sensory inputs supply visual, tactile, and inertial information used in developing a "feel" for car handling and performance. This feedback is necessary in enabling the driver to extract maximum performance from the race car. Hence the steering is an important feedback mechanism giving driver information on stability and directional control.

## II. OBJECTIVES

- To enable smooth and stable manoeuvring of the vehicle.
- To provide feedback to the drive.
- To optimize the steering effort
- Provide adjustability for parameters such as caster angle and toe.
- To select and implement the best mechanism that suits the purpose.

## III. SELECTION OF STEERING SYSTEM

A. Rack and pinion is used in most of vehicle because of the following reasons

- It reduces reaction torque on the steering wheel and provides the driver actuate feeling of existing lateral tire road friction
- It as the simplicity of mechanism reduced friction between tooth flanks.
- It has very good mechanical efficiency.
- It provides a good steering response.
- It reduces the space requirement.
- Contact between the steering rack and pinion is free play and even internal damping is maintained.
- Helical gears are used in rack and pinion steering to allow a large transverse contact ratio.

## IV. DESIGN METHODOLOGY

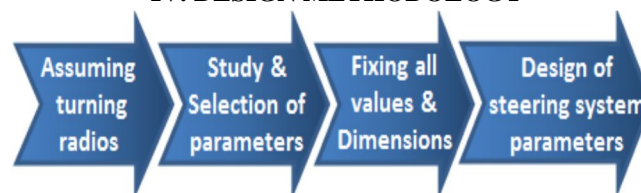

Fig.1 Design methodology

There are many types of steering systems and mechanisms are there in various automobile vehicles; but they having low response timing. For go-kart which is used for racing vehicle have to be equipped with quick response and actuating steering system for that the steering system used in this vehicle is newly designed and modified from many systems i.e. reverse pitman arm steering. Unlike

## International Journal for Research in Applied Science & Engineering Technology (IJRASET)

other systems it having steering rods connected to a single disc which is directly welded to the steering rod for zero lagging and quick response

### V. CAD MODEL

We have designed complete assembly of rack and pinion inSolid works 2015, the complete design of rack and pinion and its assembly in Solidworks2015 are shown below

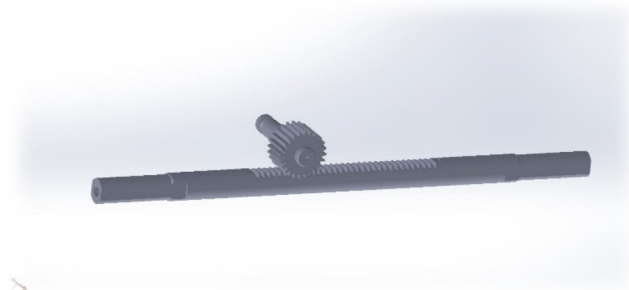

Fig.2 Cad Model of rack and Pinion

### VI. ANALYSIS OF COMPONENT

Analysis is process of analysing the components by applying load, temperature, pressure etc. and obtaining the values such as stresses (bending, tangential and normal), deformations, safety factor etc and in order to determine the safety of the components when done in practical. This Analysis gives optimum result of safety of components and minimizes the chances of failure.

Three major analyses of rack and pinion on Ansys are carried out here:

Total Deformation

Equivalent Stress

Factor of Safety

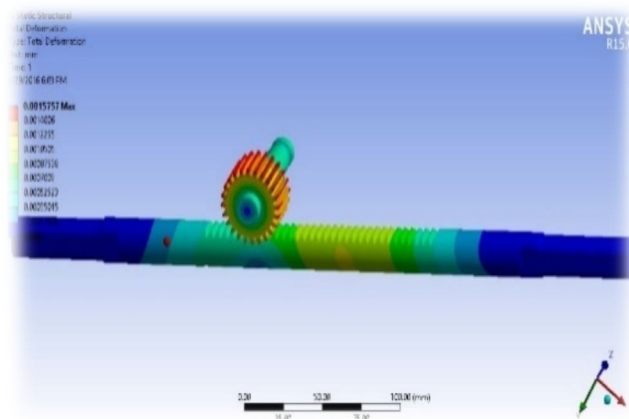

Fig.3 Total Deformation

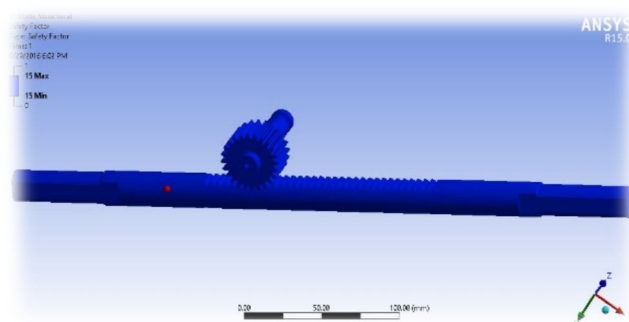

Fig.4 Factor of Safety

# International Journal for Research in Applied Science & Engineering Technology (IJRASET)

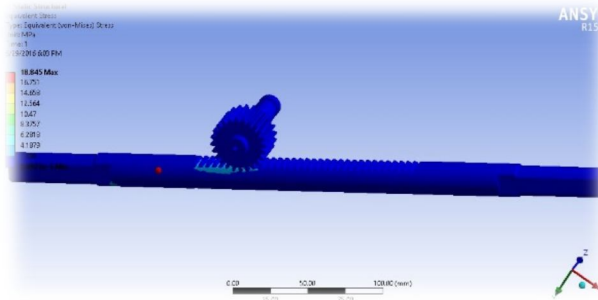

Fig.5 equivalent stress

## VII. CONSIDERATIONS

**Camber:** The camber angle is set to zero degree as there is no suspension system to provide dynamic camber during cornering.

**Caster:** It is the angle made by the kingpin with the vertical measured from the side of the tire. Positive caster angle, although increases steering effort, is necessary to obtain self-aligning torque and also enable the inside rear wheel to lift during cornering since the kart does not have a differential at the rear axle.

**Kingpin Inclination:** Due to the geometry of the stub axle the King pin offset is high, which demands large kingpin inclination to minimize scrub radius which is not feasible. Hence it is set to 0(zero) degree.

## VIII. STEERING GEOMETRY

We decided to adopt Ackerman steering geometry with rack and pinion mechanism. This geometry makes the inside wheel steer to a greater angle than the outside wheel and all the wheels roll about a common turn center. Since the cornering speeds are small, Ackerman geometry is an ideal choice. The mechanism was simulated in solid works software and after several trials the following configuration was obtained which satisfied Ackerman condition with minimal error.

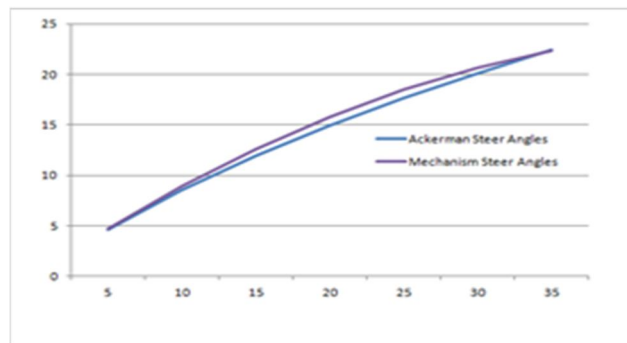

Fig.6 Steering Mechanism

TABLE.1  
OBTAINED VALUES

Steering system	Ackermann steering(rack and pinion)
Wheel base	1474.4mm
Track width	1032.5mm
Turning radius	3796.31mm
Steering ratio	4:1
Inside angle	22.73
Outside angle	30.69

## IX. CALCULATIONS

Considering the turning radius of 3m, using the

Ackerman equation for the dimensions of our go-kart, the maximum steering angles was calculated.

## International Journal for Research in Applied Science & Engineering Technology (IJRASET)

Wheelbase (L): 1474.4mm

Track width (T): 1032.08mm

Actual Turning Radius (R): 3796.31mm

OUTER ANGLE :

$$\begin{aligned}\tan A &= L / (R - d/2) \\ &= 1474.4 / (3000 - 1032.08/2) \\ \tan A &= 0.59 \\ A &= \tan^{-1}(0.59) \\ A &= 30.69\end{aligned}$$

INNER ANGLE

$$\begin{aligned}\tan B &= L / (R + d/2) \\ &= 1474.4 / (3000 + 1032.08/2) \\ \tan B &= 0.419 \\ B &= \tan^{-1}(0.419) \\ B &= 22.73\end{aligned}$$

$$\begin{aligned}\text{Actual Turning Radius :} \\ &= d/2 + L \operatorname{cosec} (30.69/2 + 22.72/2) \\ &= 3796.31 \text{ mm}\end{aligned}$$

$$\begin{aligned}\% \text{Ackermann} &= A - B / \tan^{-1}(1/\tan B - 1) - B \\ &= 30.69 - 22.73 / 31.47 \\ &= 0.96 * 100 = 96\%\end{aligned}$$

The steering ratio is set to 4:1 for a quick vehicle response.

### X. CONCLUSIONS

The manual rack and pinion steering system is not used in heavy weight vehicles due to high axle loads, although it is simple in design and easy to manufacture, therefore it is commonly used in light weight vehicles. The values calculated in the paper may differ practically due to steering linkages error or due to improper steering geometry, so these values are useful to understand the interdependency of the quantities on each other and to design an ideal manual rack and pinion system for the vehicle.

### XI. ACKNOWLEDGEMENT

The authors working on the design of steering system for an electric go-kart vehicle would like to thank all those who have sincerely and whole heartedly lend their support and contributed to the project. We express our gratitude and thankfulness to the professors for their valuable guidance and their co-operation in the project.

We are also very much thankful to Head of the Department, Mechanical Engineering and project guide for their inspiring guidance with helpful suggestions for the project. We are greatly obliged to the entire staff of the Department of Mechanical Engineering, Lords Institute of Engineering and Technology, Hyderabad.

### REFERENCES

- [1] Automobile engineering – Kirpal Singh.
- [2] Theory of machines – R.S Khurmi.
- [3] MubinaShekh,ShivamJaiswal,HimanshuPachauri,Harsha Ravi Raj,Design Of Steering System For An Electric All – Terrain Vehicle , I – Managers Journal On Mechanical Engineering , Vol.6.No.3 , Issn-2230-9055 .
- [4] S.Nithyananth,A.Jagatheesh,K.Madan,B.Nirmalkumar, Convertable Four Wheels Steering With Three Mode Operation, International Journal Of Research In Aeronautical And Mechanical Engineering, Vol.2 Issue.3, ISSN (ONLINE): 2321-3051 .
- [5] Prashant L Agrawal,SahilShaileshbhai Patel , ShivanshuRajeshbhaiParmar,Design And Simulation Of Manual Rack And Pinion Steering System , International Journal Of Science And Advance Research In Technology , Volume.2.Issue.7 , ISSN [ONLINE]: 2395-1052 .





10.22214/IJRASET



45.98



IMPACT FACTOR:  
7.129



IMPACT FACTOR:  
7.429



# INTERNATIONAL JOURNAL FOR RESEARCH

IN APPLIED SCIENCE & ENGINEERING TECHNOLOGY

Call : 08813907089  (24\*7 Support on Whatsapp)